

### MATERIAL OF CONSTRUCTION

S.NO.	PART NAME	QTY.	MATERIAL
1	BODY	1	ASTM A182/F316
2	STEM	1	AISI316/A276 . STELLITED V TIP
3	PANNEL NUT	1	AISI316
4	GLAND NUT	1	
5	WASHER	1	PTFE/GRAPHOIL
6	PACKING	1	
7	PACKING WASHER	1	AISI316/A276
8	NUT	2	
9	BACK FERRUL	2	STEEL PLATED
10	FRONT FERRUL	2	
11	GRUB SCREW	1	AISI304 . ALU.COATED
12	HANDLE	1	

### FEATURES:

316 SS CONSTRUCTION FOR CORROSION RESISTANCE.  
EXCELLENT FLOW REGULATION & LEAK TIGHT.  
ONE PIECE BODY CONSTRUCTION. NO WELDING USED.

### TESTING:

STANDARD TEST:- EACH VALVES IS TESTED WITH NITROGEN AT 1000 PSI FOR SEAT & PACKING LEAKAGE, WITH A MAX. ALLOWABLE LEAK RATE OF 0.1 SEC. / MIN.  
HYDRO TEST:- PERFORMED WITH PURE WATER AT 1-1/2 TIMES OF THE WORKING PRESSURE.

### LUBRICATION:

MOLLY ANTI-SEIZE LUBRICANT.

### NOTES:-

OPTIONAL GRAPHOL PACKING AVAILABLE FOR HIGH TEMPERATURE APPLICATION . SERIES OF END CONNECTIONS LIKE PANAM, TUBE ENDS, MALE/FEMALE NPT, BSP PIPE THREADED ENDS WITH STRAIGHT PATTERN, PANNEL NUT STD.  
VALVE CAN BE SUPPLIED TO MEET CURRENT REVISION OF NACE MR-01-75. (SOURGAS SERVICE) DIMENSIONS ARE FOR REFERENCE ONLY. SUBJECT TO CHANGE.

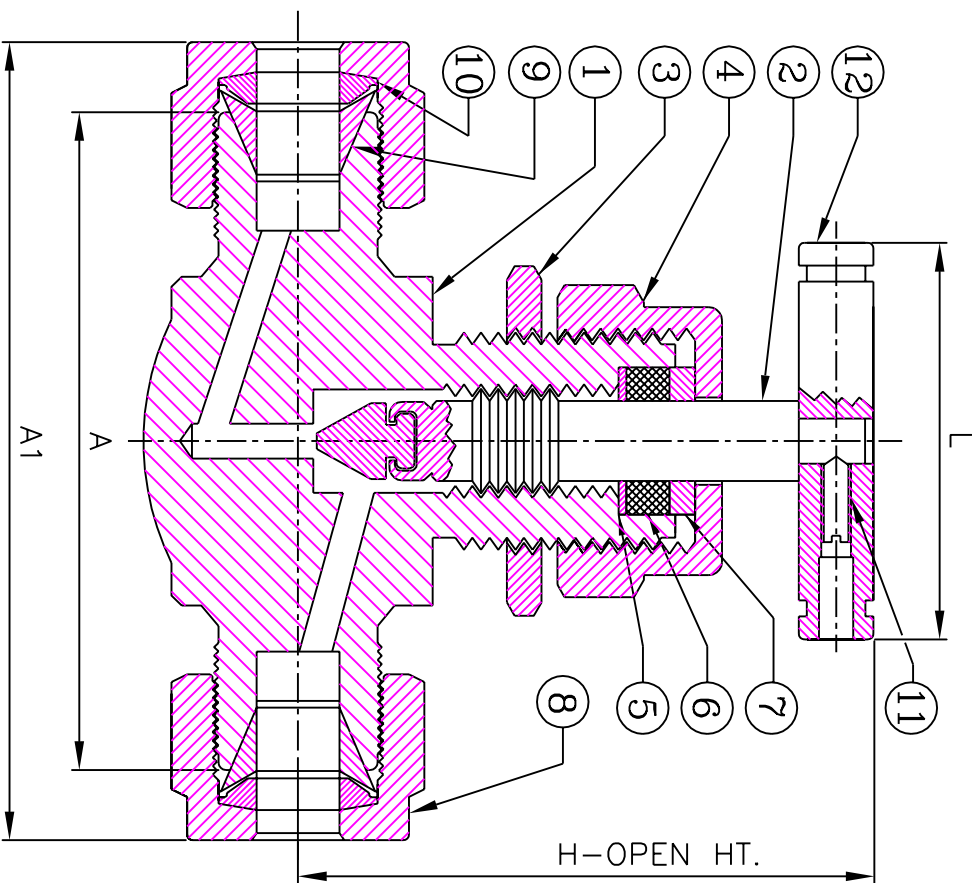

### TECHNICAL DATA

Pr. Rot.	Temp. Rot.	Cv	ORIFICE	TUBE O/D	A	A1	H	L
6000 PSI (41300 kpa)	PTFE -20 to 250° F (-29° to 121°C)	0.65	5 mm.	1/4"	45	60	55	50
				3/8"				
	GRAFOIL -20 to 600° F (-29° to 315°C)	0.80	6.5mm.	1/2"	63	85	80	60
				3/4"				
		1.90	9.5mm.	1"	82	107.5	110	70

### TABLE OF DIMENSION

TITLE:-			
"FB" SERIES NEEDLE VALVE - ODT			
DRN.	MT	SCALE	N.T.S.
CHD.	ET	DATE	07-08-2002
APPD.	JP	DRG. NO. PNV-FB-ODT	

**PANAM ENGINEERS**  
AN ISO 9001 : 2000 COMPANY  
MUMBAI - INDIA