

MATERIAL OF CONSTRUCTION

S.NO.	PART NAME	QTY.	MATERIAL
1	BODY	1	ASTM A182/F316
2	STEM	1	AISI316/A276 . STELLITED V TIP
3	PANNEL NUT	1	AISI316 /A276
4	GLAND NUT	1	
5	WASHER	1	PTFE/GRAPHOIL
6	PACKING	1	
7	PACKING WASHER	1	AISI316/A276
8	GRUB SCREW	1	STEEL PLATED
9	HANDLE	1	AISI304 . ALU.COATED

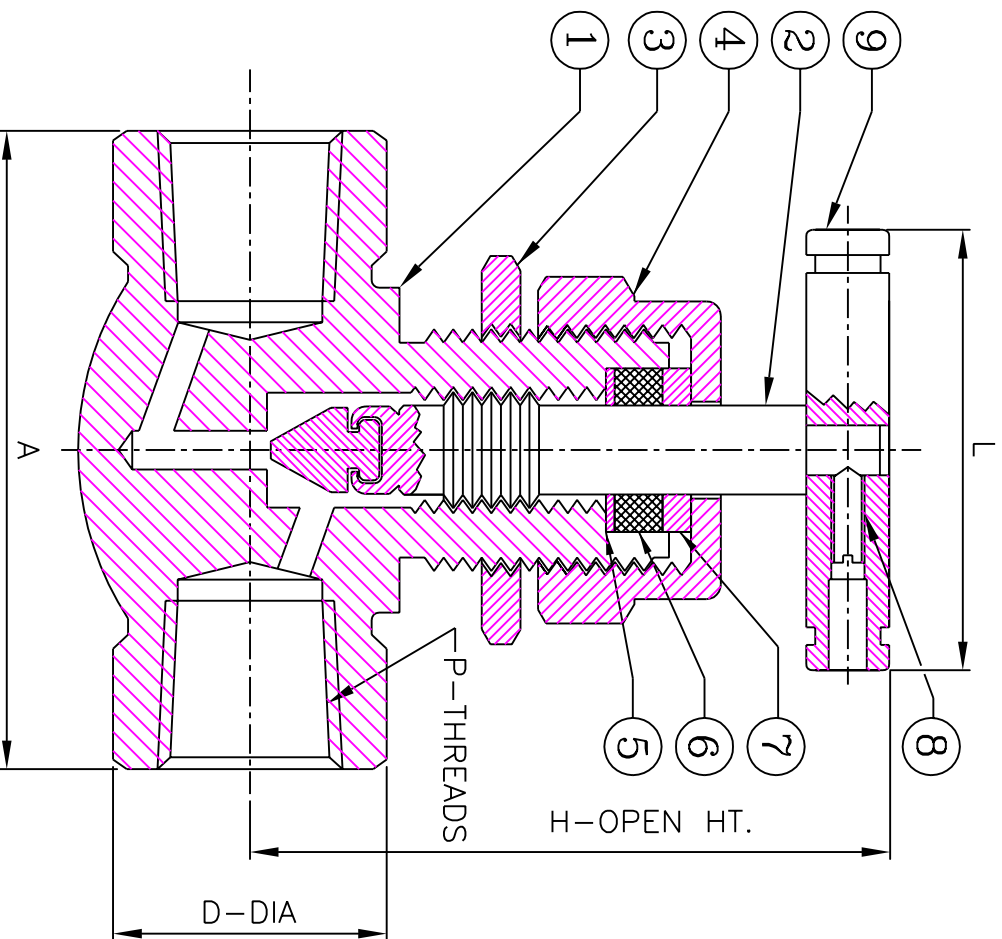

FEATURES:
 316 SS CONSTRUCTION FOR CORROSION RESISTANCE.
 EXCELLENT FLOW REGULATION & LEAK TIGHT.
 ONE PIECE BODY CONSTRUCTION. NO WELDING USED.

TESTING:
 STANDARD TEST:- EACH VALVES IS TESTED WITH NITROGEN AT 1000 PSI FOR SEAT & PACKING LEAKAGE, WITH A MAX. ALLOWABLE LEAK RATE OF 0.1 SEC. / MIN.
 HYDRO TEST:- PERFORMED WITH PURE WATER AT 1-1/2 TIMES OF THE WORKING PRESSURE.

LUBRICATION:
 MOLLY ANTI-SEIZE LUBRICANT.

NOTES:-
 OPTIONAL GRAPHOL PACKING AVAILABLE FOR HIGH TEMPERATURE APPLICATION . SERIES OF END CONNECTIONS LIKE MALE/FEMALE NPT, BSP PIPE THREADED ENDS WITH STRAIGHT PATTERN. PANNEL NUT STD.
 VALVE CAN BE SUPPLIED TO MEET CURRENT REVISION OF NACE MR-01-75. (SOURGAS SERVICE)
 DIMENSIONS ARE FOR REFERENCE ONLY. SUBJECT TO CHANGE.

TECHNICAL DATA

Pr. Rot.	Temp. Rot.	Cv	ORIFICE	P-THREADS NPTF/BSPF/BSPTF	A	D-DIA	H OPEN HT.	L
6000 PSI (41300 kpa)	PTFE -20 to 250° F (-29° to 121°C)	0.65	5 mm.	1/4"	47.5	20	55	50
							GRAFOIL -20 to 600° F (-29° to 315°C)	
		0.80	6.5mm.	3/4"	65	31	80	60
		1.90	9.5mm.	1"	84	43.5	110	70

TABLE OF DIMENSION

TITLE:-
"FB" SERIES NEEDLE VALVE- F X F

DRN.	MT	SCALE	N.T.S.
CHD.	ET	DATE	07-08-2002
APPD.	JP	DRG. NO. PNV-FB-FF	

PANAM ENGINEERS
 AN ISO 9001 : 2000 COMPANY
 MUMBAI - INDIA